

Tools needed

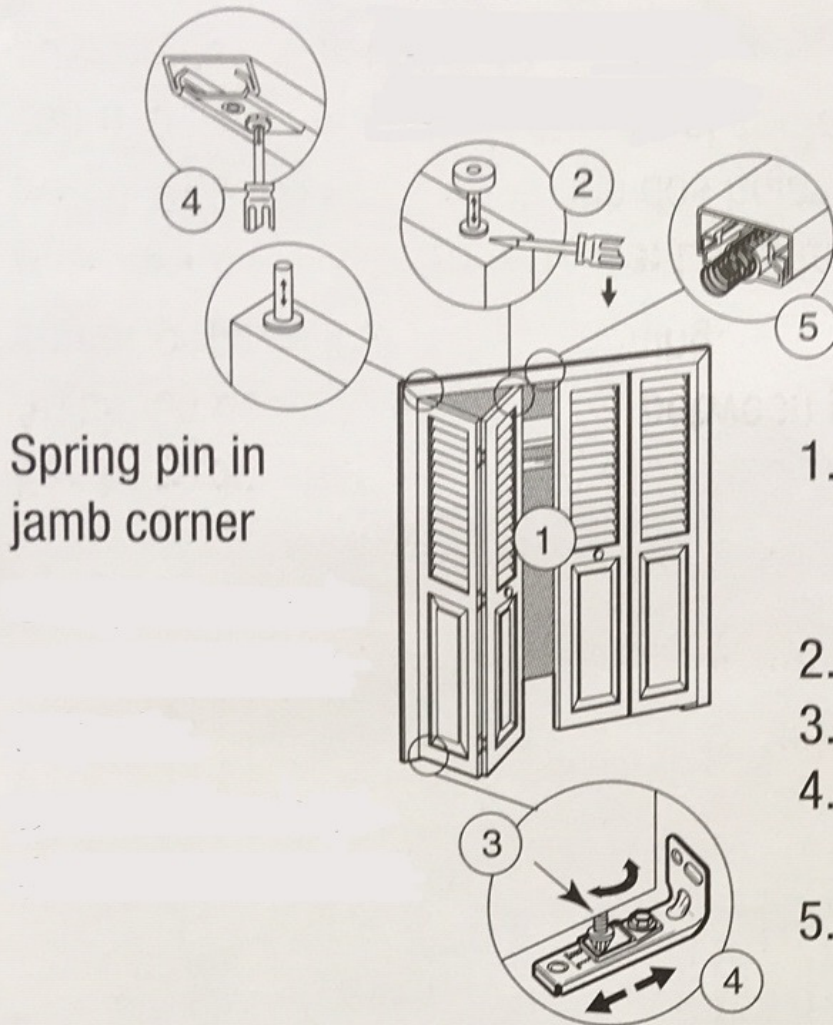

N 6545

Spring roller



Spring pin in jamb corner

1. Remove door by lifting up and tilting bottom out.
2. Replace hardware
3. Vertical adjustment
4. Horizontal adjustment
5. Snap-in snugger (spring stop)

For vertical adjustment:

Lift and rotate adjusting wheel. Doors should just clear header.

For horizontal adjustment: Lift and slide into next slot. Adjust so doors have 1/8" gap between pairs of doors at center or jamb in a 2 door opening.